

Cutting Unit Rack Assembly



1. Tools needed: 2 - 9/16 wrenches, 2 - 1/2 wrenches, 1 - 1/4 allen wrench, 1 - 5/16 allen wrench, 1 - hammer



4. Repeat this procedure for the top shelves.

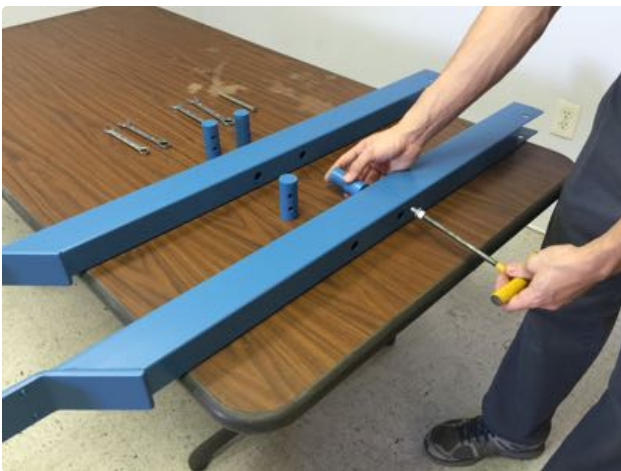

2. Attach the posts to the legs using the 3/8-16 x 3/4 socket head bolts and lock washers. Do not tighten.



5. Place the legs on a flat surface and space them apart with the bottom cross member (the one without the label) so that the holes in the cross member align with the holes on the posts.

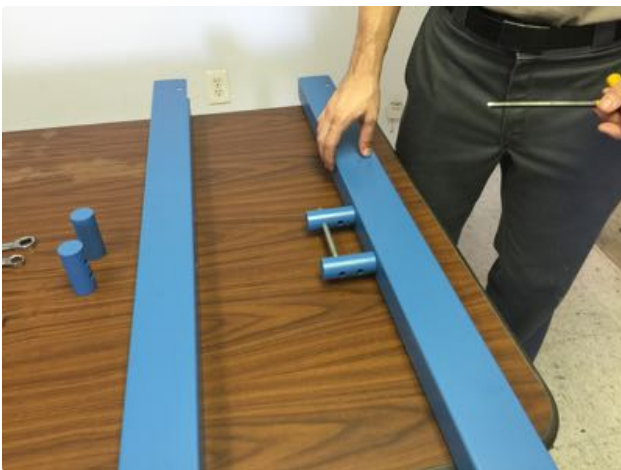

3. Align the holes of both posts using the long 3/8 bolt then tighten the bolts. Remove the long bolt.

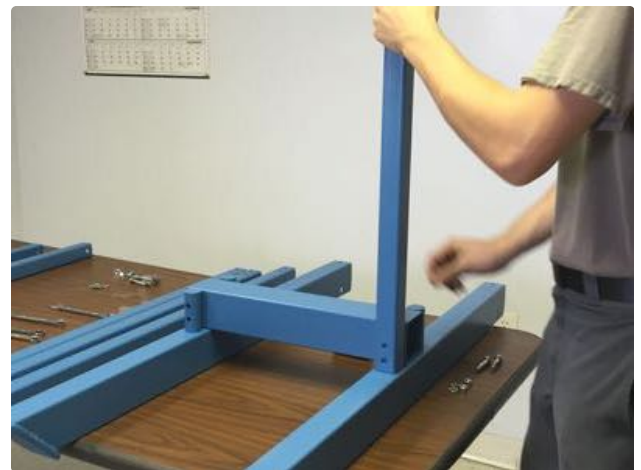

6. Place a column over a post and align the holes. Fasten using the 3/8-16 x 2 hex head bolts, lock washers and nuts. Tighten the nuts finger tight. Repeat for the other three columns.



7. Mount the casters to one end of the leg using the 5/16 -18 x 1 hex head bolts, washers, lock washers and nuts. Tighten the bolts.



10. Place one top shelf into the columns.



8. Mount and tighten the 3/8-16 x 1/2 socket head bolt and nut on to the leg.



11. Position the top cross member (the one with the label) between the columns, align the holes using the 3-8/16 x 2 hex head bolts.

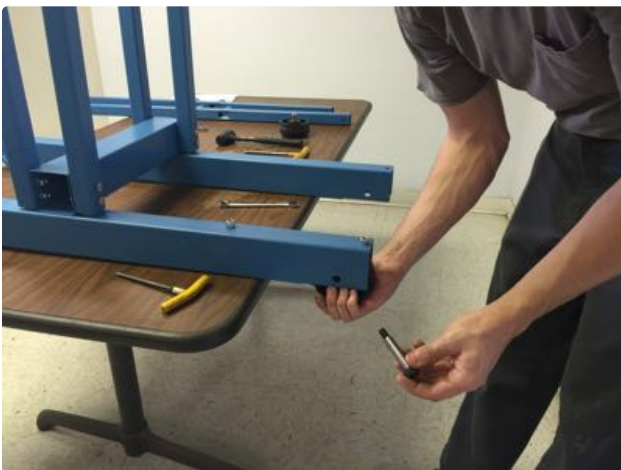

9. Mount the wheels on the end of each leg using the shoulder bolts and lock nuts. Tighten the nuts. Place the rack on the floor to complete.



12. Mount second top shelf and insert the 3/8-16 x 2 hex head bolts, lock washers and nuts.



13. You may have to loosen the bolts that hold the post in place in order to insert the bolts into the cross member.

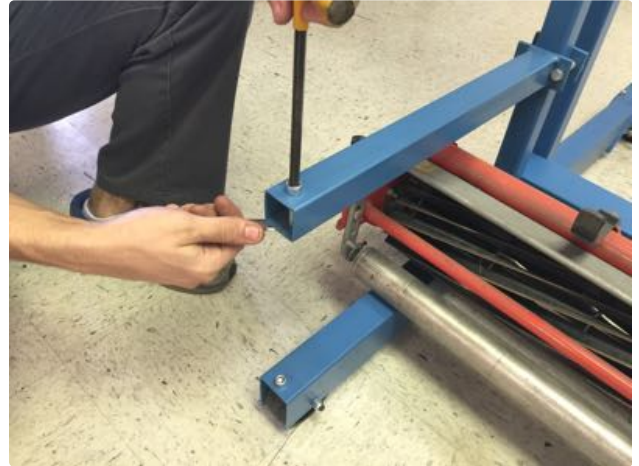

16. Place the 3/8-16 x 2 socket head bolt and nut in the hole at the end of each shelf and tighten.

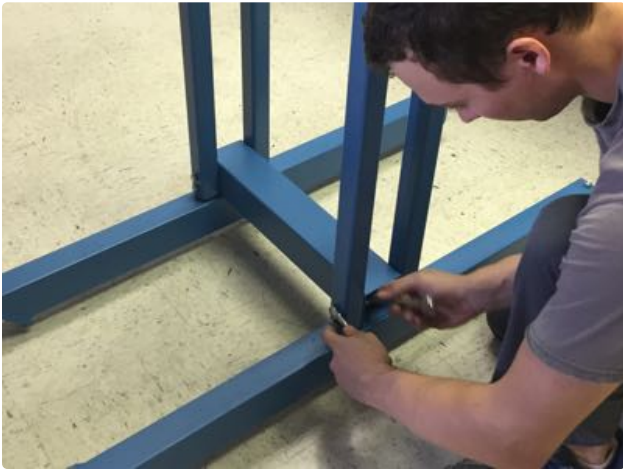

14. With the rack sitting on a flat surface, make sure that all four wheels are touching then tighten all of the 3/8-16 x 2 bolts that go through the columns, posts, and cross members.

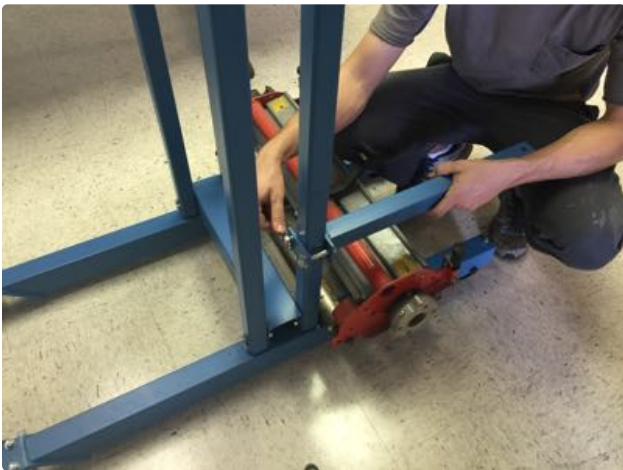

15. With a cutting unit on the bottom shelf, mount two adjustable shelves to the columns just above the cutting unit using the 3/8-16 x 2-1/2 hex head bolts, washers, lock washers and nuts. Tighten the bolts and repeat for the rest of the shelves.

Cutting Unit Rack

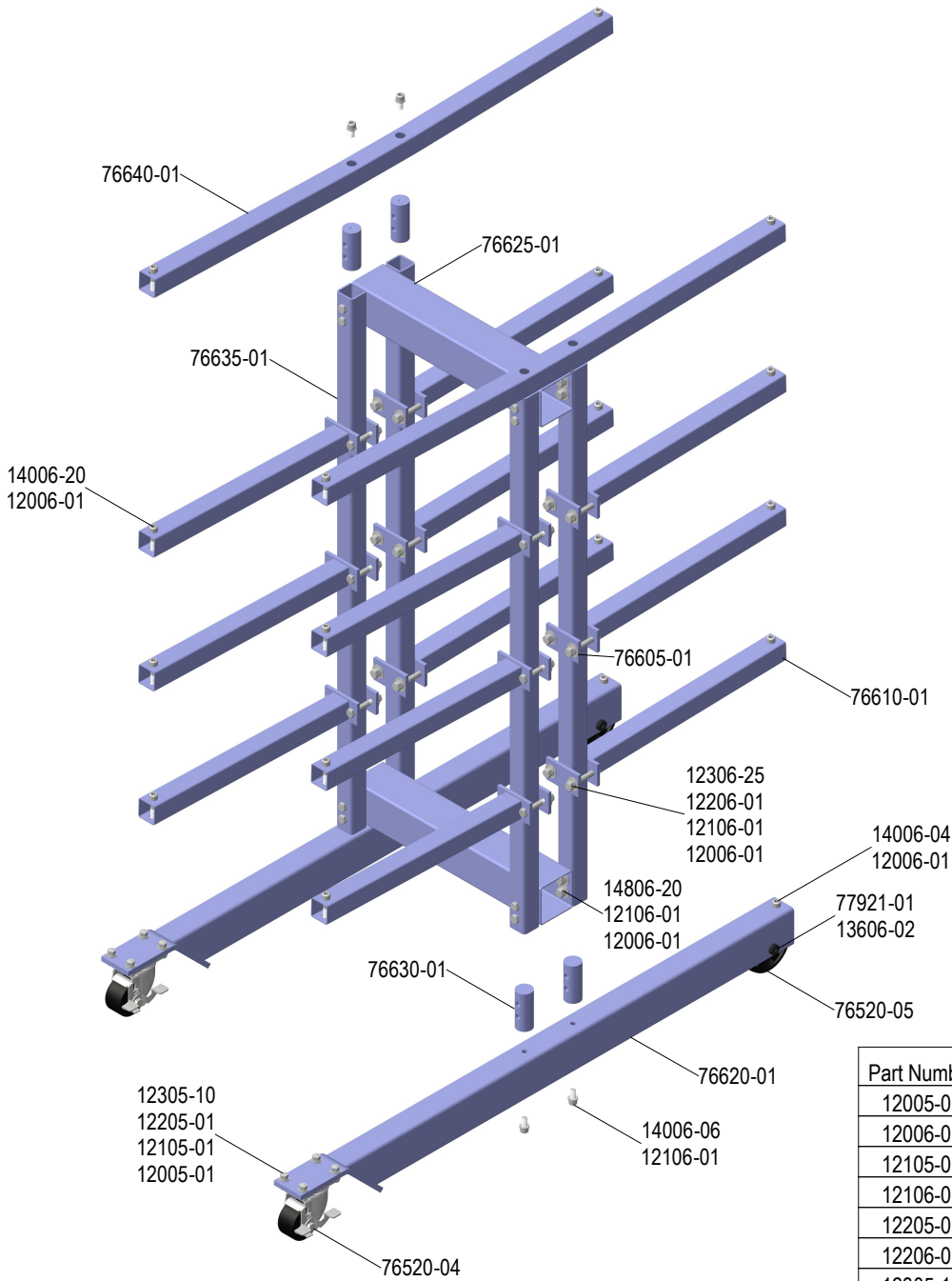

Part Number	Quantity	Description
12005-01	8 each	5/16-18 Nut
12006-01	58 each	3/8 -16 Nut
12105-01	8 each	5/16 Lock Washer
12106-01	48 each	3/8 Lock Washer
12205-01	8 each	5/16 Washer
12206-01	24 each	3/8 Washer
12305-10	8 each	5/16-18 x 1 Hex Head Bolt
12306-25	24 each	3/8-16 x 2-1/2 Hex Head Bolt
13606-02	2 each	Lock Nut
14006-04	2 each	3/8-16 x 1/2 Socket Head Bolt
14006-06	8 each	3/8-16 x 3/4 Socket Head Bolt
14006-20	16 each	3/8-16 x 2 Socket Head Bolt
14806-20	16 each	3/8-16 x 2 Hex Head Bolt
76520-04	2 each	Caster
76520-05	2 each	Wheel
76605-01	12 each	Pad
76610-01	12 each	Shelf
76620-01	2 each	Leg
76625-01	2 each	Cross Beam
76630-01	8 each	Post
76635-01	4 each	Column
76640-01	2 each	Top Shelf
77921-01	2 each	Shoulder Bolt